

## Allow Location Services for the Mapping Function to Work on the iPad

The best practice to avoid issues is to ensure that the iPad is running the correct version of iOS. Always refer to the top of the GLR Enumerator Website for notification on when it is safe to install a new version.

The iPad mapping feature will not work properly if the location services is not turned on within the iPad settings. This setting may need to be turned back on if you receive a new iPad or after running an iOS update.

Location services is found in different parts of the iPad settings depending on the version of iOS. This document shows the settings for iOS version 10.3.3.

1. Touch on the “Settings” icon:  (It may be located in the second screen of the “Do NOT Use” folder)
2. Scroll down on the left hand side and touch on: “Privacy”
3. Touch on “Location Services” on the top right
4. The proper settings should look like this:

Note: Both “Maps” and “Safari Websites” should be listed and have “While Using” to the far right of each.

### How to fix it if it doesn't look like this:

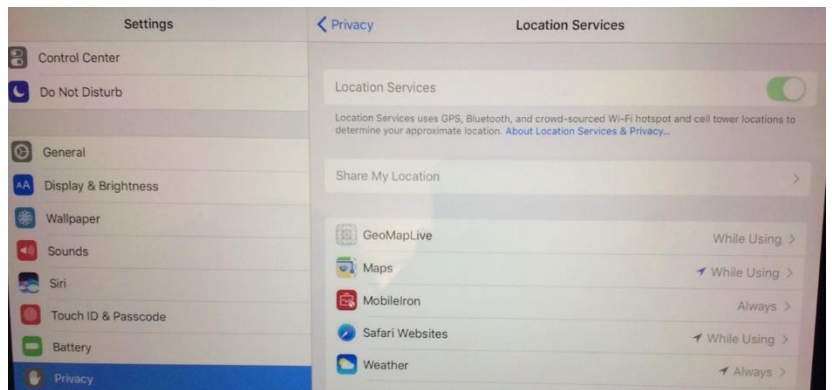

5. If Maps is shown on the listing, but it doesn't have “While Using” next to it:
  - a. Touch the arrow to the right of “Maps” and touch “While Using this App” so that it checks that item

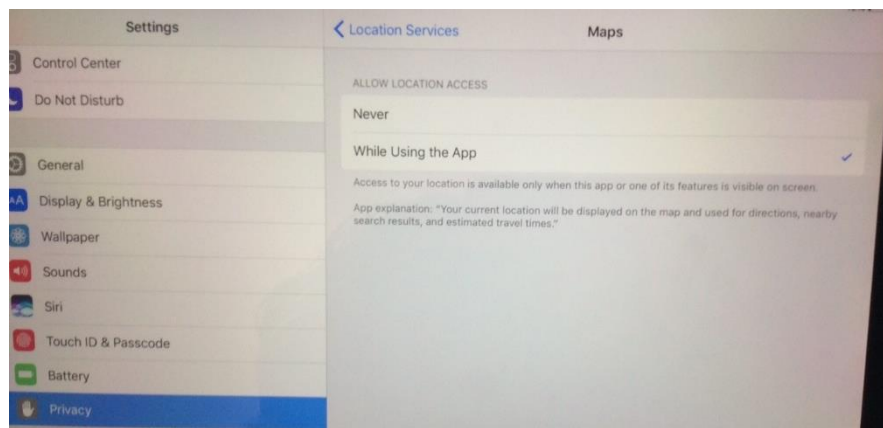

- b. Touch on “< Location Services” at the top of the screen to back up to the prior menu
6. If Safari Websites is shown on the listing, but it doesn't have “While Using” next to it:
    - a. Touch the arrow to the right of “Safari Websites” and touch “While Using this App”
    - b. Touch on “< Location Services” at the top of the screen to back up to the prior menu

7. Exit Settings by pressing the iPad Home Button located on the edge of the iPad glass:



**If either the “Maps” or “Safari Websites” were not listed on the settings screen:**

8. Open Apple Maps by touching on the Maps icon



9. Touch on “Allow” when you see this message:



10. Press the iPad Home Button to exit Maps



11. Open MOST by touching on the icon



12. Select “Training” and login

13. Touch on one of the mapping icons at the right end of one of the records

	ST	CTY	SEQ. NUM	POID	TRA	SUB	OP DOM	NAME	ADDRESS	RESP CODE	STATUS		
	18	171		300016730	1	1	99	DOE FARMS INC JOHN DOE			2017-08-10 12:23:12		
	18	157		300026440	1	1	99	DOE FARMS INC JOHN DOE			2017-08-10 15:10:15		
	18	157		300026570	1	1	99	DOE FARMS INC JOHN DOE					

14. Touch on “Allow” when you see this message:

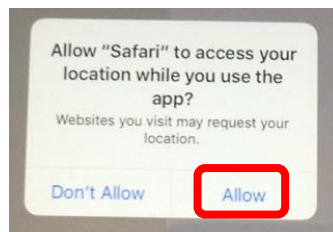

15. Press the iPad Home Button to exit Maps



Go back and complete steps 1-7 to ensure that the settings match the image provided in step 4.